

# UNFINISHED SHAFT ENDS

# Screw shaft diameter $\phi 20$ , Lead 10 (T nut)

(Unit : mm)

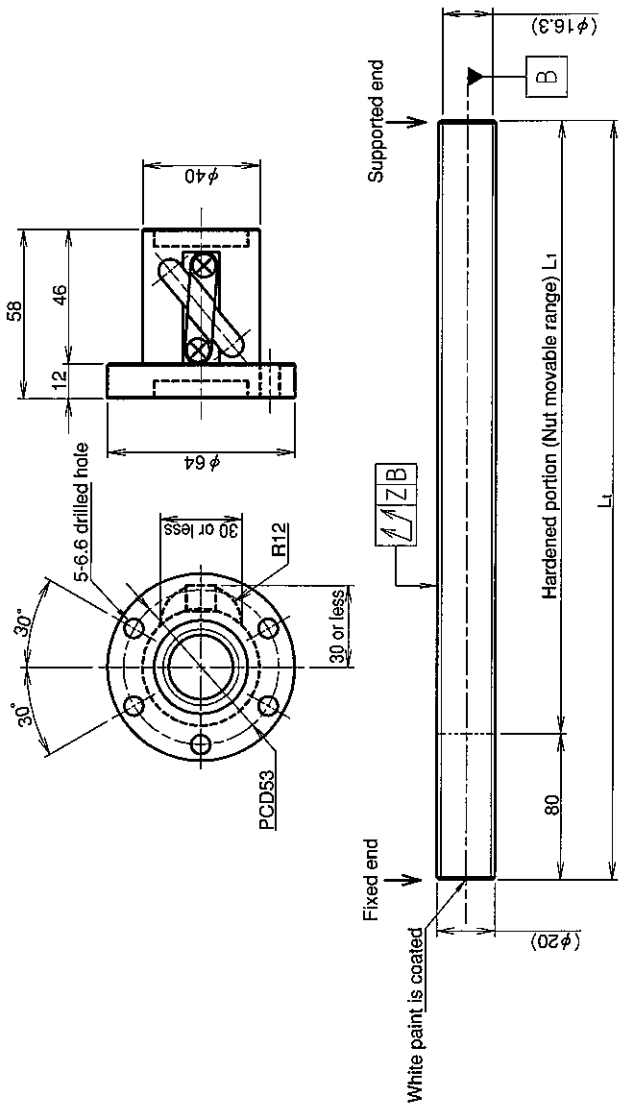

### Ball screw specifications

Screw shaft dia.	20	Basic dynamic load rating	10600N
Lead	10	Basic static load rating	22700N
Thread direction	Right-hand	Lubricant	Alvania Grease No.2
Number of circuits	2.5turn 1circuit	Surface treatment	Phosphate coating
Ball diameter	4.7625		

Model No.	Axial clearance	L <sub>1</sub>	L <sub>t</sub>	Z	Wiper
GY2010DS-CTLR-0600A	~0.150	520	600	0.140	Lip seal
GY2010DS-CTLR-1200A		1120	1200	0.240	
GY2010DS-CTLR-2000A		1920	2000	0.640	

### Table of optional specifications for each model

Additional machining of shaft end	Surface treatment (Note 1)	Difference of grease	Direction of nut	Wiper removal
○	○	○	○	○

(Note 1) The above-mentioned surface treatment is LD treatment (coating thickness : 1 to 2  $\mu$ m).

### Notation of standard rolled ball screw

- Standard length shaft without end machining (Matched screw shaft and nut)  
GY2010DS-CTLR-□□□□X□□□□-CAY
- Nut only without screw shaft  
GY2010DS-CTLR
- Screw shaft only without end machining  
GY2010ZZ-ZZZZ-□□□□D

- With end machining specified on your drawing (Matched screw shaft and nut)  
GY2010DS-CTLR-□□□□X□□□□-CAY
- With end machining specified on your drawing (Screw shaft only)  
GY2010ZZ-ZZZZ-□□□□Y□□□□-CAY

Overall length    Thread length

**SHAFT END FINISH ORDERING SHEET**

Screw shaft diameter  $\phi 20$ , Lead 10 (T nut)

(Unit : mm)

GY2010DS-CTLR-     X     -CAY

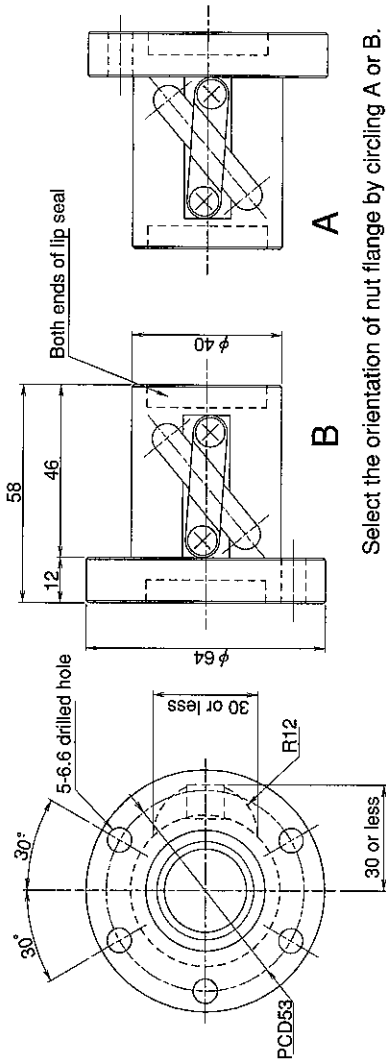

Select the orientation of nut flange by circling A or B.  
No marking means "B" orientation as default.

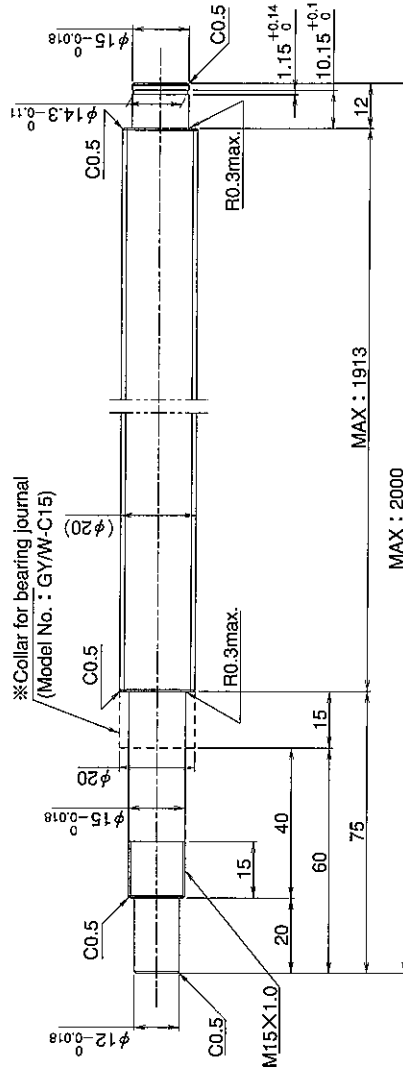

※ Please place an order for collar separately.  
Applicable Support Unit

Direct mount : BUK-15A (Fixed end unit+Supported end unit) Refer to Page.406

Circle flange : BUM-15 (Fixed end unit+Supported end bearing) Refer to Page.413

Company Name	
Telephone	Name of Person in Charge
Company Address	