

KURODA Standard Rolled Ball Screw : GY Series (Accuracy grade C10)

SHAFT END FINISH ORDERING SHEET

Screw shaft diameter $\phi 32$, Lead 10 (K nut)

(Unit : mm)

GY3210ES-NKBR- X -CAY

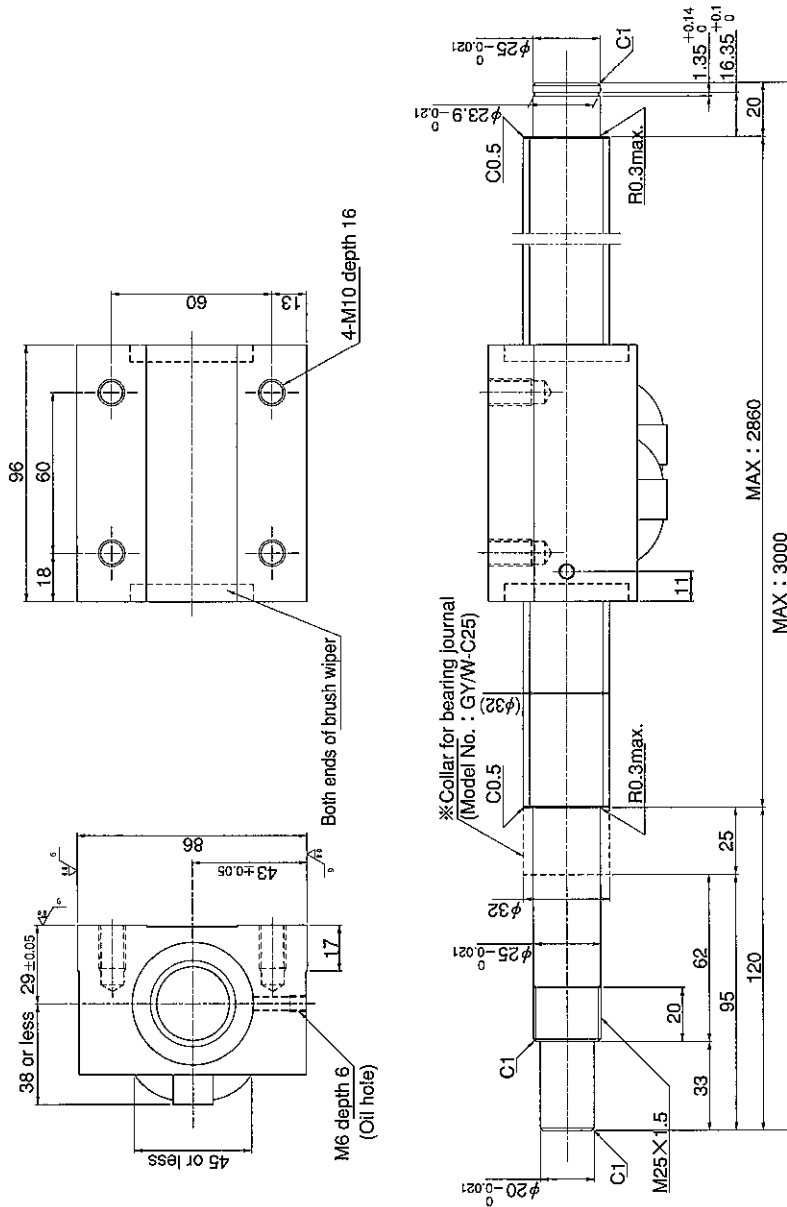

※Please place an order for collar separately.

Applicable Support Unit

Direct mount : BUK-25A (Fixed end unit+Supported end unit) Refer to Page.408

Circle flange : BUM-25 (Fixed end unit+Supported end bearing) Refer to Page.415

Company Name		
Telephone		Name of Person in Charge
Company Address		

Refer to page 24 for NOTATION OF MODEL NUMBER.