

**UNFINISHED SHAFT ENDS**

**Screw shaft diameter  $\phi 32$ , Lead 10 (U nut)**

(Unit : mm)

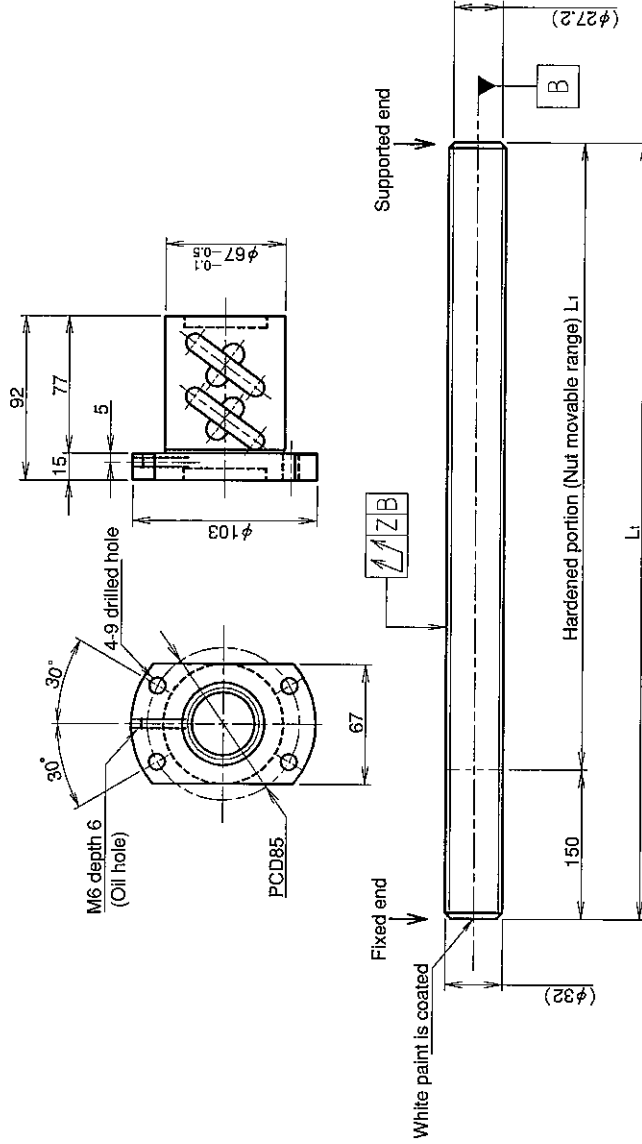

**Ball screw specifications**

Screw shaft dia.	32	Basic dynamic load rating	32800N
Lead	10	Basic static load rating	86700N
Thread direction	Right-hand	Lubricant	Alvania Grease No.2
Number of circuits	2.5turn 2circuit	Surface treatment	Phosphate coating
Ball diameter	6.350		

Model No.	Axial clearance	L <sub>1</sub>	L <sub>t</sub>	Z	Wiper
GY3210ES-HUBR-1000A	~0.200	850	1000	0.120	Brush wiper
GY3210ES-HUBR-2000A		1850	2000	0.240	
GY3210ES-HUBR-3000A		2850	3000	0.640	

**Table of optional specifications for each model**

Additional machining of shaft end	Surface treatment (Note 1)	Difference of grease	Direction of nut	Wiper removal
○	○	○	○	○

(Note 1) The above-mentioned surface treatment is LD treatment (coating thickness : 1 to 2  $\mu$ m).

**Notation of standard rolled ball screw**

- Standard length shaft without end machining (Matched screw shaft and nut)  
GY3210ES-HUBR-□□□□X□□□□□-CAY
- Nut only without screw shaft  
GY3210ES-HUBR
- Screw shaft only without end machining  
GY3210ZZ-ZZZZ-□□□□□D

- With end machining specified on your drawing (Matched screw shaft and nut)  
GY3210ES-HUBR-□□□□X□□□□□-CAY
- With end machining specified on your drawing (Screw shaft only)  
GY3210ZZ-ZZZZ-□□□□Y□□□□□-CAY

Overall length Thread length

